

INTEGRAL FLANGED VALVES- GATE TYPE- BOLTED BONNET- FULL & REDUCED PORT

150 LB.
300 LB.

Design construction:

- API 602 - ASME B16.34 - BS 5352
- Testing according to API 598
- Marking MSS SP25
- Outside Screw and Yoke (OS&Y)
- Self aligning two piece packing gland
- Spiral-wound gasket
- Integral backseat
- Integral body flanges
- Face to face according to ASME B16.10
- Flanges according to ASME B16.5
- Ratings:
- carbon steel class 150 285 psig@ 100°F
20 bar + 38°C
- carbon steel class 300 740 psig@ 100°F
51 bar + 38°C

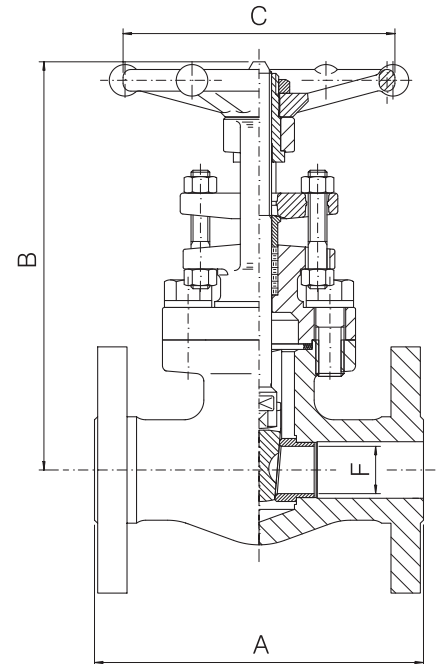

| FULL PORT – FIG. 1 10 | | | | | | |
|-----------------------|------------|-------------|---------------|--------------|--------------|--------------|
| SIZE | inch | 1/2 | 3/4 | 1 | 1 1/2 | 2 |
| | mm | 15 | 20 | 25 | 40 | 50 |
| A | inch mm | 4.25 108 | 4.62 117,5 | 5 127 | 6.50 165 | 7 178 |
| B open | inch mm | 6.88 175 | 8.26 210 | 9.05 230 | 11.41 290 | 13.39 340 |
| C | inch mm | 3.46 88 | 3.82 97 | 5.43 138 | 5.43 138 | 6.77 172 |
| F | inch mm | .55 14 | .71 18 | .94 24 | 1.44 36,6 | 1.89 48 |
| Weight | lb. kg | 7 3,2 | 10.25 4,7 | 13.25 6,1 | 25 11,4 | 39.5 18 |
| PACKING | | BH2 | BH4 | BH5 | BY5 | BY7 |
| GASKET | | G2 | G3 | G4 | G7 | G8 |

| REDUCED PORT – FIG. L1 10 | | | | | | | |
|---------------------------|------------|-------------|---------------|--------------|--------------|--------------|---------------|
| SIZE | inch | 1/2 | 3/4 | 1 | 1 1/2 | 2 | 3 |
| | mm | 15 | 20 | 25 | 40 | 50 | 75 |
| A | inch mm | 4.25 108 | 4.62 117,5 | 5 127 | 6.50 165 | 7 178 | 8 203 |
| B open | inch mm | 6.88 175 | 7.16 182 | 8.35 212 | 10.04 255 | 11.41 290 | 13.58 345 |
| C | inch mm | 3.46 88 | 3.46 88 | 3.82 97 | 5.43 138 | 5.43 138 | 6.77 172 |
| F | inch mm | .38 9,6 | .55 14 | .71 18 | 1.18 30 | 1.44 36,6 | 1.89 48 |
| Weight | lb. kg | 6.25 2,9 | 8 3,7 | 11.25 5,2 | 21 9,6 | 29 13,2 | 46.75 21,2 |
| PACKING | | BH2 | BH2 | BH4 | BH6 | BY5 | BH8 |
| GASKET | | G2 | G2 | G3 | G5 | G7 | G8 |

| FULL PORT – FIG. 3 10 | | | | | | |
|-----------------------|------------|-------------|--------------|-------------|---------------|--------------|
| SIZE | inch | 1/2 | 3/4 | 1 | 1 1/2 | 2 |
| | mm | 15 | 20 | 25 | 40 | 50 |
| A | inch mm | 5.51 140 | 6 152,5 | 6.50 165 | 7.51 191 | 8.50 216 |
| B open | inch mm | 6.89 175 | 8.26 210 | 9.05 230 | 11.42 290 | 13.39 340 |
| C | inch mm | 3.46 88 | 3.82 97 | 5.43 138 | 5.43 138 | 6.77 172 |
| F | inch mm | .55 14 | .71 18 | .94 24 | 1.44 36,6 | 1.89 48 |
| Weight | lb. kg | 8.25 3,8 | 12.25 5,6 | 15.5 7,1 | 29.75 13,5 | 41.75 19 |
| PACKING | | BH2 | BH4 | BH5 | BY5 | BY7 |
| GASKET | | G2 | G3 | G4 | G7 | G8 |

| REDUCED PORT – FIG. L3 10 | | | | | | |
|---------------------------|------------|-------------|--------------|--------------|-------------|--------------|
| SIZE | inch | 1/2 | 3/4 | 1 | 1 1/2 | 2 |
| | mm | 15 | 20 | 25 | 40 | 50 |
| A | inch mm | 5.51 140 | 6 152,5 | 6.50 165 | 7.51 191 | 8.5 216 |
| B open | inch mm | 6.89 175 | 7.17 182 | 8.35 212 | 9.84 250 | 11.42 290 |
| C | inch mm | 3.46 88 | 3.46 88 | 3.82 97 | 5.43 138 | 5.43 138 |
| F | inch mm | .38 9,6 | .55 14 | .71 18 | 1.18 30 | 1.44 36,6 |
| Weight | lb. kg | 7.75 3,6 | 11.25 5,2 | 14.75 6,7 | 28.5 13 | 33.5 15,3 |
| PACKING | | BH2 | BH2 | BH4 | BH6 | BY5 |
| GASKET | | G2 | G2 | G3 | G5 | G7 |