

BRAZOLET®

THREADED & BRAZING
IPS PIPE &
TYPE K, L, M TUBE

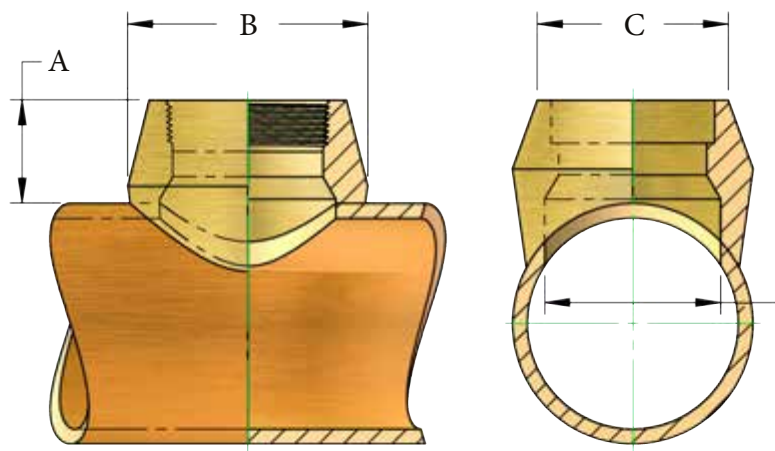

		Dimensions			Brazing Surface	F-Min. MIL-F-1183
Outlet Size		A	B	C		
IPS PIPE	NPS ¼	1 ¹ / ₁₆	1	9 ¹ / ₁₆	0.188	0.700
	NPS ⅜	1 ³ / ₁₆	1 ¼	¾	0.190	0.855
	NPS ½	1	1 7 ¹ / ₁₆	7 ⁸ / ₁₆	0.220	1.020
	NPS ¾	1 1 ¹ / ₁₆	1 11 ¹ / ₁₆	1 ½	0.240	1.250
	NPS 1	1 ¼	2 ½	1 7 ¹ / ₁₆	0.270	1.535
	NPS 1 ¼	1 5 ¹ / ₁₆	2 ½	1 ¾	0.300	1.900
	NPS 1 ½	1 ¾	2 7 ⁸ / ₁₆	2	0.330	2.160
	NPS 2	1 ½	3 ½	2 9 ¹ / ₁₆	0.360	2.675
	NPS 2 ½	1 13 ¹ / ₁₆	4	3	0.384	3.215
	NPS 3	2	4 13 ¹ / ₁₆	3 11 ¹ / ₁₆	0.442	3.880
	NPS 4	2 ¼	6	4 ¾	0.476	4.940
NPS 5	2 ¾	7 1 ¹ / ₁₆	5 9 ¹ / ₁₆	0.656	6.163	
TYPE K, L, M TUBE	NPS ¼	1 ¹ / ₁₆	1	9 ¹ / ₁₆	0.188	0.700
	NPS ⅜	1 ¹ / ₁₆	1	9 ¹ / ₁₆	0.190	0.855
	NPS ½	¾	1 ¼	¾	0.190	0.855
	NPS ¾	1	1 7 ¹ / ₁₆	7 ⁸ / ₁₆	0.220	1.020
	NPS 1	1 1 ¹ / ₁₆	1 11 ¹ / ₁₆	1 ½	0.240	1.250
	NPS 1 ¼	1 ¼	2 ½	1 7 ¹ / ₁₆	0.270	1.535
	NPS 1 ½	1 5 ¹ / ₁₆	2 ½	1 ¾	0.300	1.900
	NPS 2	1 ¾	2 7 ⁸ / ₁₆	2	0.330	2.160
	NPS 2 ½	1 ½	3 ½	2 9 ¹ / ₁₆	0.360	2.675
	NPS 3	1 5 ⁸ / ₁₆	4 ½	3	0.384	3.215
	NPS 4	2 ½	5 ½	4 5 ¹ / ₁₆	0.437	4.400

