

# INTEGRAL FLANGED VALVES- GATE TYPE- BOLTED BONNET- FULL & REDUCED PORT

**600 LB.**

**Design construction:**

API 602 - ASME B16.34 - BS 5352  
 Testing according to API 598  
 Marking MSS SP25  
 Outside Screw and Yoke (OS&Y)  
 Self aligning two piece packing gland  
 Spiral-wound gasket  
 Integral backseat  
 Integral body flanges  
 Face to face according to ASME B16.10  
 Flanges according to ASME B16.5  
 Ratings:  
 - carbon steel class 600 1480 psig @ 100°F  
 102 bar + 38°C

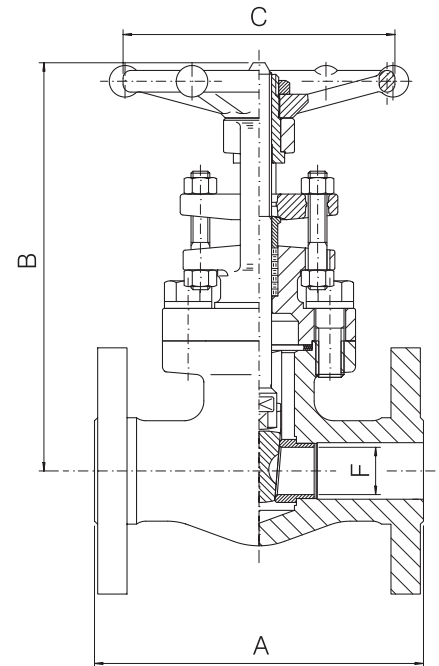

600 LB. FULL PORT – FIG. 6 10						
SIZE	inch mm	1/2 15	3/4 20	1 25	1 1/2 40	2 50
A	inch mm	6.50 165	7.51 191	8.50 216	9.50 241	11.50 292
B open	inch mm	6.89 175	8.46 215	9.45 240	11.62 295	14.17 360
C	inch mm	3.46 88	3.82 97	5.43 138	5.43 138	6.77 172
F	inch mm	.55 14	.71 18	.94 24	1.44 36.6	1.88 48
Weight	lb. kg	9.25 4,3	15.25 7	22 10	39.5 18	63.5 28
PACKING		BH2	BH4	BH5	BY5	BH8
GASKET		G2	G3	G4	G7	G9

600 LB. REDUCED PORT – FIG. L6 10						
SIZE	inch mm	1/2 15	3/4 20	1 25	1 1/2 40	2 50
A	inch mm	6.50 165	7.51 191	8.50 216	9.50 241	11.50 292
B open	inch mm	6.65 169	7.28 185	8.46 215	10.04 255	12.01 305
C	inch mm	3.46 88	3.46 88	3.82 97	5.43 138	5.43 138
F	inch mm	.38 9,6	.55 14	.71 18	1.18 30	1.44 36,6
Weight	lb. kg	9.25 4,3	15.25 7	22 10	39.5 18	63.5 28
PACKING		BH2	BH2	BH4	BH6	BY5
GASKET		G2	G2	G3	G6	G7