

# INTEGRAL FLANGED VALVES- CHECK TYPE- BOLTED BONNET- FULL PORT

**1500 LB.**

**Design construction:**  
 ASME B16.34 - BS 5352  
 Full Port Type  
 Testing according to API 598  
 Marking MSS SP25  
 Spring available on request for Piston and Ball Check Valves  
 Ring joint type gasket available on request  
 Spiral wound gasket  
 Integral body flanges  
 Face to face according to ASME B16.10  
 Flanges according to ASME B16.5  
 Ratings:  
 - carbon steel class 1500 3705 psig @ 100°F  
 255 bar + 38°C

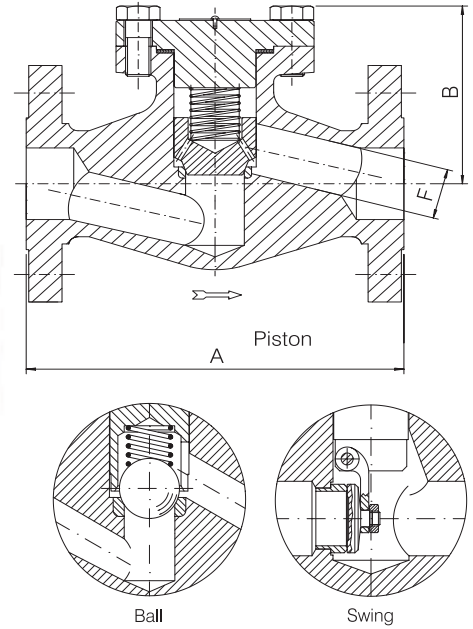

FULL PORT – FIG. 15F 40, 15F 50, 15F 60						
SIZE	inch	1/2	3/4	1	1 1/2	2
	mm	15	20	25	40	50
A	inch	8.50	9.02	10	12.01	14.50
	mm	216	229	254	305	368,5
B	inch	4.13	4.92	5.31	6.10	7.68
	mm	105	125	135	155	195
F Piston/ F Ball	inch	.47	.57	.75	1.22	1.57
	mm	12	14,5	19	31	40
F Swing	inch	.55	.71	.94	1.46	1.89
	mm	14	18	24	36,6	48
Weight	lb.	16,5	24,5	31,75	58,25	110
	kg	7,5	11,2	14,5	26,5	50
GASKET		G2	G3	G4	G7	G8